

Evron DC - CF Series 1

off-road dual-cab trayback camper

Specs & Inclusions - From \$48,300



Dimensions & Weight

- Length 1800mm x Width 2000mm x Height 1150mm
- Dry weight - TBA

Internal

- Bar frames - Aluminium
- Cupboard - 4 sliding doors in acrylic + access hatch door
- Queen size mattress - high density enviro foam
- Under bed storage
- Dust and waterproof double seals
- Diesel hot water/cabin heating
- Swivel kitchen bench with sink + hot/cold mixer tap
- Eco inline water filter system
- Double burner eco friendly stove
- Cutlery & utensil holder (black)
- Fire extinguisher - 1.1kg

Tent

- DX10 Wax Converters Australian blended poly/cotton canvas
- Canvas tent to sleep area with 4 windows and fly screen
- Tropical roof cover
- Rear awning over kitchen door - 6.5ft/2m
- Carry bag with 11 poles, pegs & ropes

Floor Plan

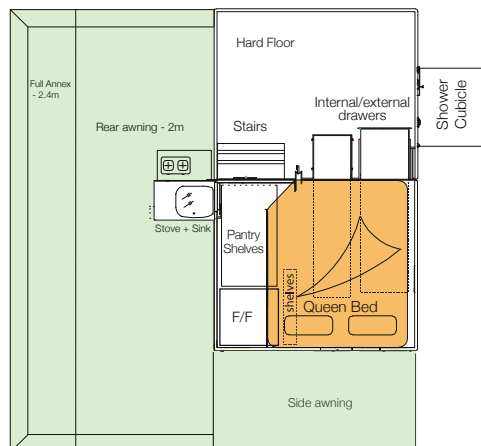

External

- Carbon fibre outer shell - lightweight structure sandwich composite panel
- External locker
- Electric pump connected to main water tank
- Aluminium frame base
- Manual wind up legs x 4 (not included in dry weight)
- Water tank sight glass
- Water tanks - 130L+ under floor tank 50L
- Tie down points - ratchet mounting straps x 4
- Shower - hot/cold mixer tap
- Shower cubicle

Electric

- Automatic set-up with 2 remote controls
- Evakool fridge/freezer upright 90L - internal capacity
- 12 volt outlet - 1 x cigarette socket + 2 x USB sockets
- Anderson plug - 50amp x 3
- Deep cycle lithium battery - 100amp hrs
- Redarc BMS 1230S - The Manager
- Fusion stereo active
- Yellow anti-bug + white LED lights
- Bed reading lights x 2

Options

- Deep cycle AGM battery - 120a/h
- Lithium battery - 100a/h
- Redarc BCDC 1240
- Single burner eco friendly stove
- Single burner butane stove
- Redarc 350w inverter
- Redarc 700w inverter
- Annex roof - 8ft/2.4m
- Annex walls - canvas
- Annex walls - midge mesh
- 2m rear awning walls - canvas
- 2m rear awning walls - midge mesh
- Laundry bag
- Privacy screen
- Innerspring mattress
- Redarc - solar blanket 112W
- Solar blanket - 150W
- Transcool - 12v evaporative air cooler
- Fujin 1.5 KW portable reverse cycle A/C
- Portable toilet - 10L waste 12L fresh water
- Honda generator EU10i
- Honda generator EU20i
- Weber BabyQ

For further information or dealer locations visit www.travelander.com.au or call 1300 2TRAVEL

Head Office: PO Box 4820, Sunshine Coast MC, Qld 4560
phone: 1300 287 283
 email: sales@travelander.com.au

